



APACH
BUILDING FUTURES



APACH
BUILDING FUTURES

APACH INDUSTRIAL CO., LTD.

176 Industrial 9th Rd., Tali Dist.,
Taichung City, Taiwan 41280

Tel +886 4 2491 5576

Fax +886 4 2491 5580

www.apach-tools.com



2018.10



DISTRIBUTOR

FOCUS! CORE! BUILDING FUTURES!

Apach Industrial's humble beginnings began in 1993 in Taichung, Taiwan known worldwide for its machining and tool making prowess. Superior technology in metals and CNC machining in conjunction with a strong Taiwanese supply base made this area thrive with quality manufacturers of pneumatic and power tools. To this day the world's top name brands still build their high value quality tools here in Taiwan.

Therefore, APACH exquisitely designs each of its air impact wrenches, and insists on strict durability testing of every piece of key components and parts, as well as rigid pre-delivery inspections of finished products. Just like Apache Indians who are physically strong and capable, APACH's products are durable and can endure under harsh working environments; hence APACH is highly recognized and sought-after by professionals worldwide. Today, APACH is a globally known brand.

APACH offers a complete product line to solve customers' problems, including all series of air impact wrench, air sander, air screwdriver, other pneumatic tools and so forth which are ideal for use in industry, automotive, motorcycle, workshop, agriculture machine and boat.

APACH's website www.apach-tools.com also provides further product information.

Underpinned by strong commitment to innovation and learning, as well as esprit de corps, APACH continues to launch new products to meet customers' special requirements, pays close attention to each customer's opinions, and provides speedy, timely services to clients. This globally prestigious brand is trustworthy.



Introduction

 **QUALITY** is how we build futures together.

100% made in TAIWAN!

- ✓ Processing
- ✓ Quality Assurance
- ✓ Assembling
- ✓ Acceptance Testing
- ✓ Packaging & Shipping



Product Index

Impact Clutches

Mechanism Chart	05
Mechanism Chart	06
Air Line Chart	06
Tool Maintenance & Safety Instruction	06

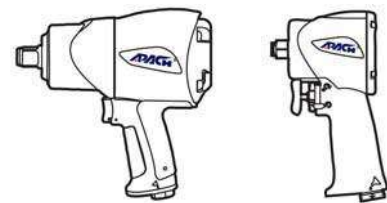

Composite Air Impact Wrench

New AW050H 1/2" Super Stubby Air Impact Wrench	08
New AW095A 1/2" Lightly Composite Air Impact Wrench	08
New AW050G 1/2" Stubby Air Impact Wrench	09
AW085C 1/2" Composite Air Impact Wrench	09
New AW150A 3/4" Lightly Composite Air Impact Wrench	10
New AW200D 1" Air Impact Wrench	10

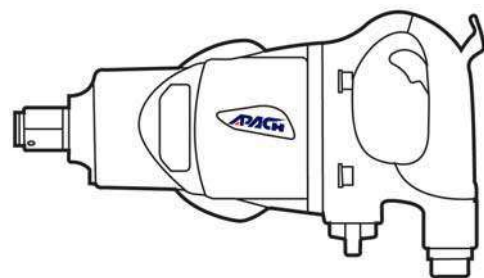

1" Air Impact Wrench

AW300A 1-1/2" Air Impact Wrench	11
AW250A 1" Air Impact Wrench	12
AW250B 1" Pin less Air Impact Wrench	12
AW200A 1" Air Impact Wrench	13
AW130B 1" Air Impact Wrench	13
AW200C 1" Air Impact Wrench	14
AW180C 1" Air Impact Wrench	14
AW130A 1" Air Impact Wrench	15
AW180B 1" Air Impact Wrench	15
AW221A 1" Air Impact Wrench	16
AW201A 1" Air Impact Wrench	16



3/4" Air Impact Wrench

AW120B 3/4" Air Impact Wrench	17
AW100A 3/4" Air Impact Wrench	17
AW080A 3/4" Air Impact Wrench	18
AW085A 3/4" Air Impact Wrench	18

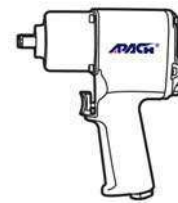

1/2" Air Impact Wrench

AW045A 1/2" Air Impact Wrench	19
AW045B 1/2" Air Impact Wrench	19
AW070B 1/2" Air Impact Wrench	20
AW065A 1/2" Air Impact Wrench	20
AW025A 1/2" Air Impact Wrench	21
AW040A 1/2" Air Impact Wrench	21
AW040B 1/2" Air Impact Wrench	22
AW040C 1/2" Air Impact Wrench	22



Stubby Air Impact Wrench

AW050E 1/2" Stubby Air Impact Wrench	23
AW050F 1/2" Stubby Air Impact Wrench	23



3/8" Air Impact Wrench

AW020A 3/8" Air Impact Wrench	25
AW020B 3/8" Air Impact Wrench	25
AW020C 3/8" Air Impact Wrench	26
AW030A 3/8" Air Impact Wrench	26

Air Screwdriver

AD312A High Torque Air Screwdriver	27
AD314A High Torque Air Screwdriver	27
AD206A High Speed Air Screwdriver	28
AD409A High Speed Air Screwdriver	28

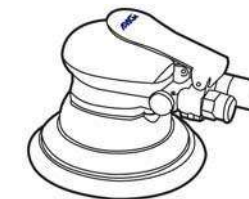

Air Sander

AS090BNV 9.0mm Random Orbital Sander	29
AS025BNV 2.5mm Random Orbital Sander	29
AS050BNV 5.0mm Random Orbital Sander	29
AS050ANV Non-Vacuum Palm Air Orbital Sander	30

Air Saw

AA700A31 Gear Air Saw	30
-----------------------	----

Air Die Grinder

AG260C2M Mini Air Die Grinder	31
AG200C2A Air Angle Die Grinder	31
AG200C2S Air Die Grinder	31
AG120C2A Air Angle Die Grinder	32
AG230C2E Extend Air Die Grinder	32
AM100B3T Precision Turbine Grinder	32
AM540B3S Air Pencil Die Grinder W/Grip	33
AM700B3S Air Pencil Die Grinder W/Grip	33
AM700B3A Right Angle Air Pencil Die Grinder W/Grip	33

Auto Shut-off Air Screwdriver

AD203BSS2 Air Screw Driver (2.6-3.0mm)	34
AD304BSS2 Air Screw Driver (3.0-4.0mm)	34
AD405BSS2 Air Screw Driver (4.0-5.0mm)	34



Air Spray Gun

AP808ARM3 Air Spray Gun	35
AP808AHM3 Air Spray Gun	35
AP350AKM1 Air Spray Gun	35
AP410AKG4 Air Spray Gun	36
AP410AHG4 Air Spray Gun	36
AP501AKS4 Air Spray Gun	36
AP607AKG5 Air Spray Gun	37
AV140A40 Air Pressure Regulator	37

Mechanism Chart



Pin Clutch Hammer Mechanism

- Extremely stable and smooth torque during operation
- Lower noise, less vibration
- Exceptional durability, easy to service
- For automotive service work and better for assembly lines
- One cycle, spring with drive cam & base and two hammer pins

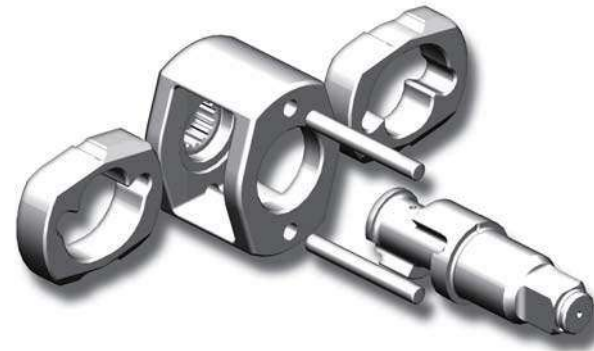

Twin Hammer Mechanism

- High torque when starting with good continuity
- Endurable impact with consistent torque for long time work
- Quick loosening and tightening for superior performance
- Constructed with precision components and impact mechanism
- One cycle, two hammers

Mechanism Chart

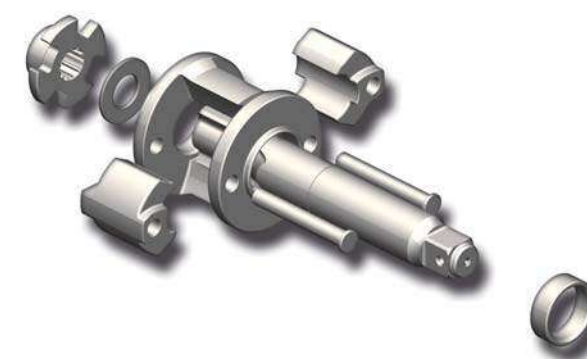

Two Hammer Mechanism

- Instantaneous high torque with stability.
- Constructed with precision components and impact mechanism.
- Quick loosening and tightening for superior performance.
- Ideal for automotive service work and assembly lines.
- One cycle, two hammers.



Pinless Hammer Mechanism

- One body structure impact mechanism by way of hammer bar and hammer dog
- Endurable and heavy-duty impact mechanism
- An instant blow of strong torque
- Ideal for heavy work



Jumbo Hammer Mechanism

- Balanced, stable, and smooth torque during operation
- Exceptional durability and long life, easy to service
- Suitable for light duty automotive service work
- No accidental starting without hurts to the bolts.
- One cycle, one hammer.

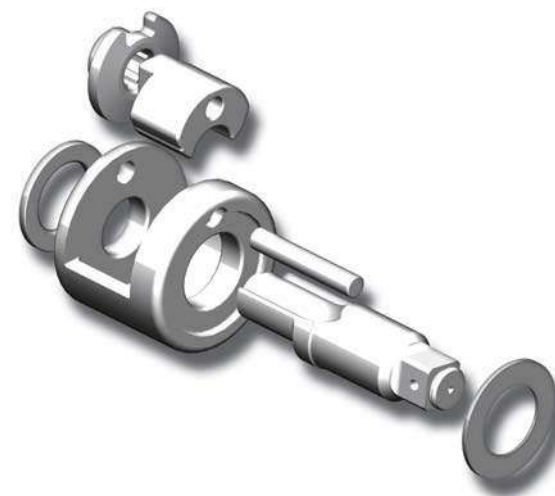

Rocking Dog Hammer Mechanism

- Medium torque without torque of accidental starting
- Suitable for removing and tightening applications of automotive service work
- Simpler impact mechanism, easy to service
- Better for DIY users and non-professional assemblers

Air line chart & Air Diagram

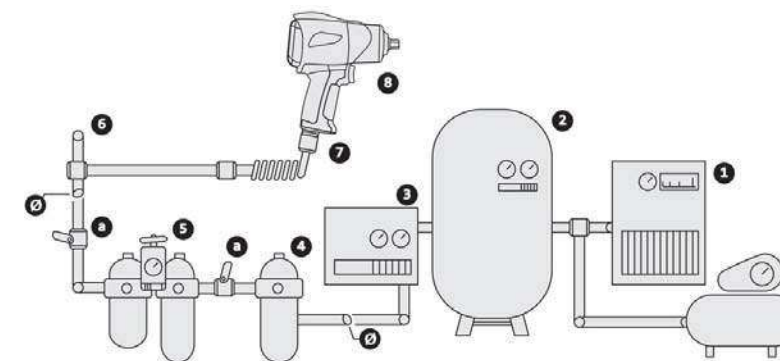

1. AIR COMPRESSOR
2. AIR TANK
3. AIR DRYER
4. OIL FILTER
 - a. SHUT-OFF COCK
5. FLITER REGULATOR / LUBRICATOR
 - a. SHUT-OFF COCK
6. DAILY WATER DRAIN
7. PRESSURE CHECK POINT
8. AIR TOOLS

Tool maintenance & safety instruction

- Always keep the air pressure at 90psi (6.3kg/cm²)
- Use proper sockets, couplers, nipples, air hose (don't over 8 feet), pipes and fitting.
- Check the condition of air line accessories, and drain out the water from the separators and air line to keep the air supply system cleaning and dry.
- Check the quick change couplers is in secure connection and in good order.
- Keep the tools properly lubricated to prevent wear and rust.
- Be sure to fill in SAE#10 Lubricating oil into the air inlet before and after using air tools.
- Always use gloves, safety goggles or face shield and ear protector when operating air tools.
- Never wear loose clothing that might get caught in the tool and cause injuries.
- When installing whip hoses or quick coupler directly into the tool, use a liquid pipe sealant to prevent damage to the housing.
- When tools are not in using, clean and lubricate them, then store in a clean and dry place

Common Applications

 Industry, Assembling Line

 Boat

 Automotive

 Agriculture Machine

 Truck

 Structure

 Motorcycle

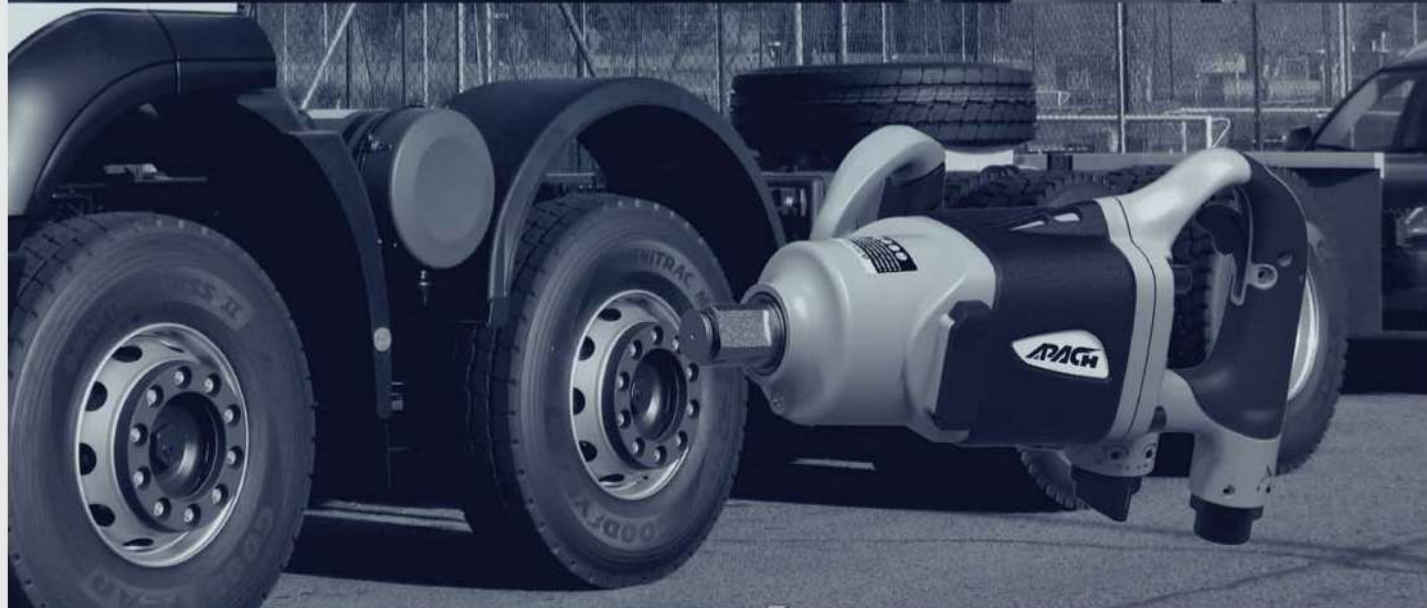

AW050H *New!*

1/2" Super Stubby Air Impact Wrench



Application



Features

- Mechanism: Jumbo Hammer
- Highest durable Japanese steel anvil
- Handle exhaust. Die casting of housing
- One hand operation for Forward & Reverse: 3 position for each side
- **Replaceable anvil design for short sockets & bits or change to traditional anvil of 3/8" and 1/2"**
- Short Length: Only 3.3" from front to rear allows for easy access in cramped spaces
- Components with durable and heavy duty materials
- Kit set : 3/8", 1/2" Adapter ; 8mm, 10mm Bit Holder ; Socket :13, 17, 19, 21mm & 14mm ext. ; Bit : 14H & T60

Tool Specifications

Square Drive	1/2"
Bolt Capacity	5/8" (M16)
Avg/ Air Con.	4.0 CFM (113 L/min)
Air Inlet	1/4"
Air Pressure	90 PSI (6.2 Bar)
Hose Size I.D.	3/8"
Working Torque	400 FT-LB / 542 N.m.
Max. Torque	600 FT-LB / 813 N.m.
Free Speed	9000 RPM
Vibration	11.6 m/s ²
Sound Pressure Level	94.5 Dba
Overall Length	3.3" (84 mm)
Net Weight	1.35 Kg (2.98 LB)

AW095A *New!*

1/2" Lightly Composite Air Impact Wrench



Application



Features

- Mechanism : Twin Hammer
- Composite and magnesium material
- Highest durable Japanese steel anvilHandle exhaust
- Forward : 3 positions; Reverse : 1 position
- The Nut-Busting Torque could be reached to **1,200 ft-lb/ 1,620 Nm**
- The cylinder is using material of FCD45 and has special heat treat, it has high wear resistance.
- Blade with spring mounted, make sure the blades can be opened when working!
- Simple structure, easy to service and repair!

Tool Specifications • 10 Pcs/19.0 Kg/20.0 Kg/1.71'

Square Drive	1/2 "
Bolt Capacity	1" (M25)
Avg/ Air Con.	5.5 CFM (158 L/min)
Air Inlet	1/4"
Air Pressure	90 PSI (6.2 Bar)
Hose Size I.D.	3/8"
Working Torque	800 FT-LB / 1080 N.m.
Max. Torque	950 FT-LB / 1283 N.m.
Free Speed	8500 RPM
Vibration	8.1 m/s ²
Sound Pressure Level	91.5 Dba
Overall Length	6-7/8" (179 mm)
Net Weight	1.7 Kg (3.75 LB)

AW050G *New!*

1/2" Stubby Air Impact Wrench



Application



Features

- Mechanism: Jumbo Hammer
- Highest durable Japanese steel anvil
- Handle exhaust
- One hand operation for Forward & Reverse; 3 position for each side
- Die casting of housing
- Powerful torque with Low noise
- Components with durable and heavy duty materials
- Short Length: Only 3-7/8" from front to rear allows for easy access in cramped spaces

Tool Specifications

Square Drive	1/2"
Bolt Capacity	5/8" (M16)
Avg/ Air Con.	4.0 CFM (113 L/min)
Air Inlet	1/4"
Air Pressure	90 PSI (6.2 Bar)
Hose Size I. D.	3/8"
Working Torque	450 FT-LB / 610 N.m.
Max . Torque	600 FT-LB / 813 N.m.
Free Speed Vibration	9000 RPM
Sound Pressure Level	11.6 m/s2
Overall Length	-
Net Weight	3.87" (99 mm)
	1.33 Kg (2.93 LB)

AW150A *New!*

3/4" Lightly Composite Air Impact Wrench



Application



Features

- Mechanism: Twin Hammer
- Composite and magnesium material
- Highest durable Japanese steel anvil
- Handle exhaust
- Forward: 3 positions; Reverse: 1 position
- The Nut-Busting Torque could be reached to 1,600 ft-lb/ 2250 Nm,
- The cylinder is using material of FCD45 and has special heat treat, it has high wear resistance.
- Blade with spring mounted, make sure the blades can be opened when working!
- Simple structure, easy to service and repair!

Tool Specifications

Square Drive	3/4"
Bolt Capacity	1-1/4" (M32)
Avg/ Air Con.	7.0 CFM (198 L/min)
Air Inlet	3/8"
Air Pressure	90 PSI (6.2 Bar)
Hose Size I. D.	3/8"
Working Torque	1200 FT-LB / 1687 N.m.
Max . Torque	1500 FT-LB / 2108 N.m.
Free Speed Vibration	6000 RPM
Sound Pressure Level	9.6 m/s2
Overall Length	96.5 DbA
Net Weight	8-1/4" (209 mm)
	3.0 Kg (6.4 LB)

AW085C

1/2" Composite Air Impact Wrench



Application



Features

- Mechanism : Twin Hammer
- Highest durable grade steel anvil
- Handle exhaust
- Powerful torque and excellent continuity in the same tool's field
- Light weight with composite material
- Forward 3 position; Reverse : 1 position
- Hose fitting can swirl

Tool Specifications • 10 Pcs/24.0 Kg/25.0 Kg/1.71'

Square Drive	1/2"
Bolt Capacity	7/8" (M24)
Avg/ Air Con.	5.3 CFM (150 L/min)
Air Inlet	1/4"
Air Pressure	90 PSI (6.2 Bar)
Hose Size I.D.	3/8"
Working Torque	650 FT-LB / 881 N.m.
Max . Torque	840 FT-LB / 1139 N.m.
Free Speed Vibration	9500 RPM
Sound Pressure Level	4.6 m/s2
Overall Length	101.9 DbA
Net Weight	7-7/8" (200 mm)
	2.2 Kg (4.8 LB)

AW200D *New!*

1" Air Impact Wrench



Application



Features

- Mechanism: Twin Hammer
- Highest durable steel Anvil (standard & 6" optional)
- Top exhaust or bottom exhaust
- Forward & Reverse : 3 position for each side
- Heavy duty casting of housing
- Inside or outside trigger available
- Components with durable and heavy duty materials
- Inside or outside trigger available
- Kit set available : (sockets: 21, 22, 24, 27, 30, 36, 38, 41mm x 90L)

Tool Specifications

Square Drive	1"
Bolt Capacity	1-3/8" (M33)
Avg/ Air Con.	6.94 CFM (196 L/min)
Air Inlet	1/2"
Air Pressure	90 PSI (6.2 Bar)
Hose Size I.D.	1/2"
Working Torque	1800 FT-LB / 2440 N.m.
Max . Torque	2000 FT-LB / 2712 N.m.
Free Speed Vibration	6100 RPM
Sound Pressure Level	5.8 m/s2
Overall Length	-
Net Weight	19-3/8" (490 mm)
	6.9 Kg (16.25 LB)

1-1/2" Air Impact Wrench

AW300A

1-1/2" Air Impact Wrench



Features

- Mechanism: Twin Hammer
- Highest durable Japanese steel Anvil (2", 6" & 8" optional)
- Top exhaust
- Lever reverse is with a red rubber for protecting hand
- Forward & Reverse: 4 position for each side
- Heavy duty casting of housing
- Components with durable and heavy duty materials
- Inside or outside trigger available

Tool Specifications • 1 pc/17.2Kgs/17.7kgs/1.32'

Square Drive	1-1/2"
Bolt Capacity	1-3/4" (M44)
Avg/ Air Con.	7.0 CFM (198 L/min)
Air Inlet	1/2"
Air Pressure	90 PSI (6.2 Bar)
Hose Size I.D.	1/2"
Torque (5 Sec.)	2400 FT-LB / 3254 N.m.
Max. Torque (10 Sec.)	3000 FT-LB / 4068 N.m.
Free Speed	3700 RPM
Vibration	5.9 m/s ²
Sound Pressure Level	96 DbA
Overall Length	19-1/4" (490 mm)
Net Weight	15.2 Kg (33.5 LB)

Application



1" Air Impact Wrench

AW250A

1" Air Impact Wrench



Features

- Mechanism : Twin Hammer
- Highest durable Japanese steel Anvil (2", 6" & 8" optional)
- Front exhaust
- Lever reverse is with a red rubber for protecting hand
- Forward & Reverse : 3 position for each side
- Heavy duty casting of housing
- Components with durable and heavy duty materials
- Inside or outside trigger available

Tool Specifications • 1 Pc/16.0Kg/16.6kg/1.32'

Square Drive	1"
Bolt Capacity	1-1/2" (M38)
Avg/ Air Con.	7.4 CFM (195 L/min)
Air Inlet	1/2"
Air Pressure	90 PSI (6.2 Bar)
Hose Size I.D.	1/2"
Torque (5 Sec.)	2200 FT-LB / 2983 N.m.
Max. Torque (10 Sec.)	2500 FT-LB / 3390 N.m.
Free Speed	3000 RPM
Vibration	6.0 m/s ²
Sound Pressure Level	96 DbA
Overall Length	19-1/4" (490 mm)
Net Weight	14.0 Kg (30.8 LB)

Application



AW250B

1" Pin Less Air Impact Wrench



Features

- Mechanism : Pin Less
- Highest durable Japanese steel Anvil with long lifespan
- Front exhaust
- Lever reverse is with a red rubber for protecting hand
- Forward & Reverse : 3 position for each side
- Heavy duty casting of housing
- Components with durable and heavy duty materials
- Inside or outside trigger available
- Low air consumption designed(save electric) with high torque

Tool Specifications • 1 Pc/18.0Kg/18.5kg/1.32'

Square Drive	1"
Bolt Capacity	1-1/2" (M38)
Avg/ Air Con.	6.0 CFM (170 L/min)
Air Inlet	1/2"
Air Pressure	90 PSI (6.2 Bar)
Hose Size I.D.	1/2"
Torque (5 Sec.)	2200 FT-LB / 2983 N.m.
Max. Torque (10 Sec.)	2500 FT-LB / 3390 N.m.
Free Speed	3800 RPM
Vibration	6.1 m/s ²
Sound Pressure Level	98 DbA
Overall Length	23-1/4" (620 mm)
Net Weight	16.0 Kg (35.4 LB)

Application



AW200A

1" Air Impact Wrench



Features

- Mechanism : Twin Hammer
- Highest durable Japanese steel Anvil (2", 6" & 8" optional)
- Top exhaust
- Lever reverse is with a red rubber for protecting hand
- Forward & Reverse: 3 position for each side
- Heavy duty casting of housing
- Components with durable and heavy duty materials
- Inside or outside trigger available

Tool Specifications • 2 Pcs/19.7Kg/20.5kg/1.5'

Square Drive	1"
Bolt Capacity	1-3/8" (M35)
Avg/ Air Con.	6.9 CFM (197 L/min)
Air Inlet	1/2"
Air Pressure	90 - 115 PSI (6.2-7.9 Bar)
Hose Size I.D.	1/2"
Torque (5 Sec.)	1700 FT-LB / 2305 N.m.
Max. Torque (10 Sec.)	2000 FT-LB / 2712 N.m.
Free Speed	4100 RPM
Vibration	5.8 m/s ²
Sound Pressure Level	91 Db
Overall Length	13-3/4" (335 mm)
Net Weight	8.88 Kg (22.0 LB)

Application



AW200C

1" Air Impact Wrench



Features

- Mechanism : Pin Clutch
- Highest durable steel Anvil (2", 6" & 8" optional)
- Top exhaust
- Forward & Reverse : 3 position for each side
- Heavy duty casting of housing
- Components with durable and heavy duty materials
- Inside or outside trigger available

Tool Specifications • 2 Pcs/22.9Kg/23.7kg/1.5'

Square Drive	1"
Bolt Capacity	1-3/8" (M35)
Avg/ Air Con.	6.0 CFM (170 L/min)
Air Inlet	1/2"
Air Pressure	90 PSI (6.2 Bar)
Hose Size I.D.	1/2"
Torque (5 Sec.)	1800 FT-LB / 2440 N.m.
Max. Torque (10 Sec.)	2000 FT-LB / 2712 N.m.
Free Speed	3300 RPM
Vibration	5.8 m/s ²
Sound Pressure Level	91 Db
Overall Length	13.78" (350 mm)
Net Weight	10.5 Kg (23.15 LB)

Application



AW130B

1" Air Impact Wrench



Features

- Mechanism : Two Hammer
- Highest durable steel Anvil (2", 6" & 8" optional)
- Front exhaust
- Forward & Reverse: 1 position for each side
- Powerful instantaneous torque with stability
- Heavy duty casting of housing
- Inside or outside trigger available
- Components with durable and heavy duty materials

Tool Specifications • 1 Pc/15.6Kg/16.3kg/1.32'

Square Drive	1"
Bolt Capacity	1-1/4" (M32)
Avg/ Air Con.	7.4 CFM (210 L/min)
Air Inlet	1/2"
Air Pressure	90 PSI (6.2 Bar)
Hose Size I.D.	1/2"
Torque (5 Sec.)	1000 FT-LB / 1356 N.m.
Max. Torque (10 Sec.)	1300 FT-LB / 1763 N.m.
Free Speed	3500 RPM
Vibration	5.8 m/s ²
Sound Pressure Level	105 Db
Overall Length	16-1/2" (420 mm)
Net Weight	13.6 Kg (30.0 LB)

Application



AW180C

1" Air Impact Wrench



Features

- Mechanism : Rocking Dog
- Highest durable steel Anvil (2" & 8" optional)
- Front exhaust
- Forward & Reverse : 4 position for each side
- Quick tightening and losing for application of big automobiles and heavy machines
- Heavy duty casting of housing
- Components with durable and heavy duty materials
- Inside or outside trigger available

Tool Specifications • 1 Pcs/17.7Kg/18.4kg/1.32'

Square Drive	1"
Bolt Capacity	1-5/16" (M34)
Avg/ Air Con.	6.0 CFM (170 L/min)
Air Inlet	1/2"
Air Pressure	90 PSI (6.2 Bar)
Hose Size I.D.	1/2"
Torque (5 Sec.)	1600 FT-LB / 2169 N.m.
Max. Torque (10 Sec.)	1800 FT-LB / 2441 N.m.
Free Speed	3200 RPM
Vibration	6.5 m/s ²
Sound Pressure Level	96 Db
Overall Length	18-3/8" (470 mm)
Net Weight	17.1 Kg (37.7 LB)

Application



AW130A

1" Air Impact Wrench



Application



Features

- Mechanism : Rocking Dog
- Highest durable steel Anvil (2", 6" & 8" optional)
- Top exhaust
- Forward & Reverse: 3 position for each side
- Heavy duty casting of housing
- Economic type for operator convenience
- Components with durable and heavy duty materials
- Inside or outside trigger available

Tool Specifications • 2 Pcs/22.3Kg/23.1kg/1.5'

Square Drive	1"
Bolt Capacity	1-1/4" (M32)
Avg/ Air Con.	6.0 CFM (170.0 L/min)
Air Inlet	1/2"
Air Pressure	90 PSI (6.2 Bar)
Hose Size I.D.	1/2"
Torque (5 Sec.)	1000 FT-LB / 1356 N.m.
Max. Torque (10 Sec.)	1300 FT-LB / 1763 N.m.
Free Speed	3300 RPM
Vibration	6.5 m/s ²
Sound Pressure Level	90 Dba
Overall Length	17-1/2" (350 mm)
Net Weight	10.1 Kg (22.3 LB)

AW221A

1" Air Impact Wrench



Application



Features

- Mechanism : Twin Hammer
- Highest durable Japanese steel Anvil (2" & 6" optional)
- Front slant exhaust
- Forward & Reverse : 3 position for each side
- Die casting of housing
- Light weight with high torque
- Components with durable and heavy duty materials

Tool Specifications • 2 Pcs/17.3Kg/17.9kg/1.1'

Square Drive	1"
Bolt Capacity	1-3/8" (M35)
Avg/ Air Con.	6.0 CFM (170.0 L/min)
Air Inlet	1/2"
Air Pressure	90 PSI (6.2 Bar)
Hose Size I.D.	1/2"
Torque (5 Sec.)	1800 FT-LB / 2440 N.m.
Max. Torque (10 Sec.)	2200 FT-LB / 2983 N.m.
Free Speed	5000 RPM
Vibration	5.9 m/s ²
Sound Pressure Level	87 Dba
Overall Length	11-1/2" (290 mm)
Net Weight	7.9 Kg (17.5 LB)

AW180B

1" Air Impact Wrench



Application



Features

- Mechanism : Twin Hammer
- Highest durable Japanese steel Anvil (2", 6" & 8" optional)
- Top exhaust
- Forward & Reverse : 3 position for each side
- Heavy duty casting of housing
- Weight less comparing with equal torque output models as AW180A.
- Components with durable and heavy duty materials
- Kit set available for : (sockets : 21, 22, 24, 27, 30, 36, 38,41mm x 90L)
- Inside or outside trigger available

Tool Specifications • 2 Pcs/18.5Kg/19.4kg/1.5'

Square Drive	1"
Bolt Capacity	1-3/8" (M35)
Avg/ Air Con.	6,94 CFM (196 L/min)
Air Inlet	1/2"
Air Pressure	90 PSI (6.2 Bar)
Hose Size I.D.	1/2"
Torque (5 Sec.)	1800 FT-LB / 2440 N.m.
Max. Torque (10 Sec.)	2000 FT-LB / 2712 N.m.
Free Speed	3300 RPM
Vibration	6.0 m/s ²
Sound Pressure Level	96 Dba
Overall Length	17-1/2" (350 mm)
Net Weight	8,3 Kg (18,3 LB)

AW201A

1" Air Impact Wrench



Application



Features

- Mechanism : Pin Clutch
- Highest durable steel Anvil (2" & 6" optional)
- Front exhaust
- Forward & Reverse : 3 position for each side
- Die casting of housing
- Pistol style design, comfort and convenience to operators
- Powerful torque with excellent continuity
- Components with durable and heavy duty materials

Tool Specifications • 2 Pcs/21.8Kgs/22.4kgs/1.1'

Square Drive	1"
Bolt Capacity	1-3/8" (M35)
Avg/ Air Con.	6,0 CFM (170.0 L/min)
Air Inlet	1/2"
Air Pressure	90 PSI (6.2 Bar)
Hose Size I.D.	1/2"
Torque (5 Sec.)	1800 FT-LB / 2440 N.m.
Max. Torque (10 Sec.)	2000 FT-LB / 2712 N.m.
Free Speed	3400 RPM
Vibration	5,8 m/s ²
Sound Pressure Level	87 Dba
Overall Length	11-1/2" (290 mm)
Net Weight	10,0 Kg (22,0 LB)

AW120B

3/4" Air Impact Wrench



Application



Features

- Mechanism : Twin Hammer
- Pistol type design, comfort and convenience to operators
- Highest durable Japan's steel anvil (2" & 6" optional)
- Handle exhaust
- Forward 3 position; Reverse : 2 position
- Powerful torque with excellent continuity
- Heavy duty casting of housing
- Components with durable and heavy duty materials
- Kit set available : (sockets: 26, 27, 29, 30, 32, 35, 36, 38mm.)

Tool Specifications • 4 Pcs/22.3Kg/23.1Kg/1.15'

Square Drive	3/4"
Bolt Capacity	1-5/16" (M34)
Avg/ Air Con.	8.4 CFM (238 L/min)
Air Inlet	3/8"
Air Pressure	90 PSI (6.2 Bar)
Hose Size I.D.	1/2"
Torque (5 Sec.)	1200 FT-LB / 1627 N.m.
Max. Torque (10 Sec.)	1500 FT-LB / 2034 N.m.
Free Speed	5000 RPM
Vibration	6.4 m/s2
Sound Pressure Level	91 Db
Overall Length	8-1/2" (216.5 mm)
Net Weight	5.1 Kg (11.2 LB)

AW080A

3/4" Air Impact Wrench



Application



Features

- Mechanism : Pin clutch
- Hand push reciprocating forward-reverse switch, and high-low speed regulator
- Highest durable grade steel anvil
- Front exhaust
- Powerful, stable and continuous torque
- Components with durable and heavy duty materials
- Quieter operation, less vibration
- Die casting of housing
- Kit set available : (sockets: 26, 27, 29, 30, 32, 35, 36, 38mm.)

Tool Specifications • 4 Pcs/20.1 Kg/20.8 Kg/1.21'

Square Drive	3/4"
Bolt Capacity	7/8" (M24)
Avg/ Air Con.	4.2 CFM (119 L/min)
Air Inlet	1/4"
Air Pressure	90 PSI (6.2 Bar)
Hose Size I.D.	3/8"
Torque (5 Sec.)	700 FT-LB / 949 N.m.
Max. Torque (10 Sec.)	800 FT-LB / 1085 N.m.
Free Speed	4800 RPM
Vibration	5.8 m/s2
Sound Pressure Level	86 Db
Overall Length	9-3/4" (248 mm)
Net Weight	4.6 Kg (10.1 LB)

AW100A

3/4" Air Impact Wrench



Application



Features

- Mechanism : Twin Hammer
- Hand push reciprocating forward-reverse switch, and high-low speed regulator
- Highest durable Japan's steel anvil
- Front exhaust
- Light weight and short length for narrow area
- Excellent power-weight ratio
- Components with durable and heavy duty materials
- Two piece housing for easy service
- Air circulation is good in housing which can make front housing cold down
- Die casting of housing
- Kit set available : (sockets: 26, 27, 29, 30, 32, 35, 36, 38mm.)

Tool Specifications • 4 Pcs/18.7Kg/19.3Kg/1.21'

Square Drive	3/4"
Bolt Capacity	1" (M25)
Avg/ Air Con.	5.30 CFM (150 L/min)
Air Inlet	1/4"
Air Pressure	90 PSI (6.2 Bar)
Hose Size I.D.	3/8"
Torque (5 Sec.)	1400 FT-LB / 1763 N.m.
Max. Torque (10 Sec.)	1600 FT-LB / 2169 N.m.
Free Speed	6500 RPM
Vibration	5.8 m/s2
Sound Pressure Level	92 Db
Overall Length	8-1/4" (210 mm)
Net Weight	4.3 Kg (9.5 LB)

AW085A

3/4" Air Impact Wrench



Application



Features

- Mechanism : Pin Clutch
- Hand push reciprocating forward-reverse switch, and high-low speed regulator
- Highest durable grade steel anvil
- Front exhaust
- Powerful, stable and continuous torque
- Components with durable and heavy duty materials
- Quieter operation, less vibration
- Die casting of housing
- Excellent power-weight ratio, good integral design, and attractive profile
- Kit set available : (sockets: 26, 27, 29, 30, 32, 35, 36, 38mm.)

Tool Specifications • 4 Pcs/21.3Kg/22.1Kg/1.15'

Square Drive	3/4"
Bolt Capacity	7/8" (M24)
Avg/ Air Con.	4.2 CFM (119 L/min)
Air Inlet	1/4"
Air Pressure	90 PSI (6.2 Bar)
Hose Size I.D.	3/8"
Torque (5 Sec.)	700 FT-LB / 949 N.m.
Max. Torque (10 Sec.)	800 FT-LB / 1085 N.m.
Free Speed	4700 RPM
Vibration	5.8 m/s2
Sound Pressure Level	86 Db
Overall Length	9-3/4" (248 mm)
Net Weight	5.0 Kg (11 LB)

AW045A

1/2" Air Impact Wrench



Application



Features

- Mechanism: Twin Hammer
- Highest durable grade steel anvil
- Front exhaust
- Forward and Reverse: 5 position on side
- Die casting of housing
- Components with durable and heavy duty materials
- Muffler available for lower noise
- Kit set available : (sockets: 9, 10, 11, 13, 14, 17 ,19 ,22, 24, 27mm & 5" Ext. bar)

Tool Specifications • 10 Pcs/28.1 Kg/29.0 Kg/1.71'

Square Drive	1/2"
Bolt Capacity	5/8" (M16)
Avg/ Air Con.	4.5 CFM (127 L/min)
Air Inlet	1/4"
Air Pressure	90 PSI (6.2 Bar)
Hose Size I.D.	3/8"
Torque (5 Sec.)	460 FT-LB / 624 N.m.
Max. Torque (10 Sec.)	550 FT-LB / 746 N.m.
Free Speed	7000 RPM
Vibration	4.6 m/s2
Sound Pressure Level	89 DbA
Overall Length	7-3/8" (188 mm)
Net Weight	2.5 Kg (5.5 LB)

AW070B

1/2" Air Impact Wrench



Application



Features

- Mechanism: Twin Hammer
- Highest durable Japanese steel anvil
- Handle exhaust
- Forward: 3 positions; Reverse: 1 position
- Die casting of housing
- Low consumption and high torque output.
- Components with durable and heavy duty materials
- Kit set available : (sockets: 9, 10, 11, 13, 14, 17 ,19 ,22, 24, 27mm & 5" Ext. bar)

Tool Specifications • 10 Pcs/27.0 Kg/27.9 Kg/1.71'

Square Drive	1/2"
Bolt Capacity	3/4" (M19)
Avg/ Air Con.	4.7 CFM (133 L/min)
Air Inlet	1/4"
Air Pressure	90 PSI (6.2 Bar)
Hose Size I.D.	3/8"
Torque (5 Sec.)	620 FT-LB / 813 N.m.
Max. Torque (10 Sec.)	720 FT-LB / 976 N.m.
Free Speed	9200 RPM
Vibration	4.3 m/s2
Sound Pressure Level	86 DbA
Overall Length	6-3/8" (162 mm)
Net Weight	2.4 Kg (5.29 LB)

AW045B

1/2" Air Impact Wrench



Application



Features

- Mechanism: Twin Hammer
- Highest durable grade steel anvil
- Handle exhaust
- Forward and Reverse: 5 position on side
- Die casting of housing
- Components with durable and heavy duty materials
- Muffler available for lower noise
- Kit set available : (sockets: 9, 10, 11, 13, 14, 17 ,19 ,22, 24, 27mm & 5" Ext. bar)

Tool Specifications • 10 Pcs/28.2 Kg/29.1 Kg/1.71'

Square Drive	1/2"
Bolt Capacity	5/8" (M16)
Avg/ Air Con.	4.5 CFM (127 L/min)
Air Inlet	1/4"
Air Pressure	90 PSI (6.2 Bar)
Hose Size I.D.	3/8"
Torque (5 Sec.)	460 FT-LB / 624 N.m.
Max. Torque (10 Sec.)	550 FT-LB / 746 N.m.
Free Speed	7000 RPM
Vibration	4.6 m/s2
Sound Pressure Level	89 DbA
Overall Length	7-3/8" (188 mm)
Net Weight	2.5 Kg (5.5 LB)

AW065A

1/2" Air Impact Wrench



Application



Features

- Mechanism: Twin Hammer
- Highest durable Japanese steel anvil
- Handle exhaust
- Forward 3 position; Reverse: 2 position
- Components with durable and heavy duty materials
- Muffler available
- Die casting of housing

Tool Specifications • 10 Pcs/28.8 Kg/29.7 Kg/1.71'

Square Drive	1/2"
Bolt Capacity	3/4" (M19)
Avg/ Air Con.	4.7 CFM (133 L/min)
Air Inlet	1/4"
Air Pressure	90 PSI (6.2 Bar)
Hose Size I.D.	3/8"
Torque (5 Sec.)	550 FT-LB / 745 N.m.
Max. Torque (10 Sec.)	650 FT-LB / 881 N.m.
Free Speed	8400 RPM
Vibration	4.5 m/s2
Sound Pressure Level	85 DbA
Overall Length	8" (204 mm)
Net Weight	2.6 Kg (5.7 LB)

AW025A

1/2" Air Impact Wrench



Application



Features

- Mechanism : Rocking Dog
- Highest durable grade steel anvil
- Front exhaust
- Hand Push reciprocating forward-reverse switch, and high-low speed regulator
- Die casting of housing
- Components with durable and heavy duty materials
- Kit set available : (sockets: 9, 10, 11, 13, 14, 17, 19, 22, 24, 27mm & 5" Ext. bar)

Tool Specifications • 10 Pcs/26.9Kg/27.7Kg/1.71'

Square Drive	1/2"
Bolt Capacity	9/16" (M14)
Avg/ Air Con.	4.2 CFM (119 L/min)
Air Inlet	1/4"
Air Pressure	90 PSI (6.2 Bar)
Hose Size I.D.	3/8"
Torque (5 Sec.)	250 FT-LB / 339 N.m.
Max. Torque (10 Sec.)	270 FT-LB / 366 N.m.
Free Speed	7500 RPM
Vibration	5.7 m/s2
Sound Pressure Level	88 Db
Overall Length	9-3/4" (248 mm)
Net Weight	2.5 Kg (5.5 LB)

AW040B

1/2" Air Impact Wrench



Application



Features

- Mechanism : Pin Clutch
- Highest durable grade steel anvil
- Front exhaust
- Hand Push reciprocating forward-reverse switch, and high-low speed regulator
- Low noise, low vibration and light weight
- Die casting of housing
- Components with durable and heavy duty materials
- Kit set available : (sockets: 9, 10, 11, 13, 14, 17, 19, 22, 24, 27mm & 5" Ext. bar)

Tool Specifications • 10 Pcs/23.5Kg/24.3Kg/1.71'

Square Drive	1/2"
Bolt Capacity	9/16" (M14)
Avg/ Air Con.	4.2 CFM (119 L/min)
Air Inlet	1/4"
Air Pressure	90 PSI (6.2 Bar)
Hose Size I.D.	3/8"
Torque (5 Sec.)	280 FT-LB / 380 N.m.
Max. Torque (10 Sec.)	340 FT-LB / 461 N.m.
Free Speed	7900 RPM
Vibration	4.2 m/s2
Sound Pressure Level	88 Db
Overall Length	7-3/8" (188 mm)
Net Weight	2.0 Kg (4.4 LB)

AW040A

1/2" Air Impact Wrench



Application



Features

- Mechanism : Pin Clutch
- Highest durable grade steel anvil
- Front exhaust
- Hand Push reciprocating forward-reverse switch, and high-low speed regulator
- Low noise, low vibration and light weight
- Die casting of housing
- Two piece housing for easy service
- Components with durable and heavy duty materials
- Kit set available : (sockets: 9, 10, 11, 13, 14, 17, 19, 22, 24, 27mm & 5" Ext. bar)

Tool Specifications • 10 Pcs/25.5Kg/26.3Kg/1.71'

Square Drive	1/2"
Bolt Capacity	9/16" (M14)
Avg/ Air Con.	3.5 CFM (92 L/min)
Air Inlet	1/4"
Air Pressure	90 PSI (6.2 Bar)
Hose Size I.D.	3/8"
Torque (5 Sec.)	280 FT-LB / 380 N.m.
Max. Torque (10 Sec.)	340 FT-LB / 461 N.m.
Free Speed	8200 RPM
Vibration	4.2 m/s2
Sound Pressure Level	88 Db
Overall Length	7-3/8" (188 mm)
Net Weight	2.2 Kg (4.85 LB)

AW040C

1/2" Air Impact Wrench



Application



Features

- Mechanism : Pin Clutch
- Highest durable grade steel anvil
- Front exhaust
- Powerful torque with adjustable torque and speed by power regulator
- Hand Push reciprocating forward-reverse switch, and high-low speed regulator
- Low noise, low vibration and light weight
- Die casting of housing
- Two piece housing for easy service
- Components with durable and heavy duty materials
- Kit set available : (sockets: 10, 11, 13, 14, 16, 17, 19, 21, 22, 24mm & 5" Ext. bar)

Tool Specifications • 10 Pcs/28.7Kg/29.5Kg/1.71'

Square Drive	1/2"
Bolt Capacity	9/16" (M14)
Avg/ Air Con.	3.7 CFM (105 L/min)
Air Inlet	1/4"
Air Pressure	90 PSI (6.2 Bar)
Hose Size I.D.	3/8"
Torque (5 Sec.)	350 FT-LB / 475 N.m.
Max. Torque (10 Sec.)	400 FT-LB / 542 N.m.
Free Speed	8200 RPM
Vibration	4.6 m/s2
Sound Pressure Level	88 Db
Overall Length	7-9/16" (193 mm)
Net Weight	2.6 Kg (5.7 LB)

AW050E

1/2" Stubby Air Impact Wrench



Application



Features

- Mechanism : Jumbo Hammer
- Highest durable Japanese steel anvil
- Handle exhaust
- Forward 3 position; Reverse : 2 position
- Die casting of housing
- Powerful torque with Low noise
- Two piece housing for easy service
- Short Length : Only 3-3/4" from front to rear allows for easy access in cramped spaces
- Components with durable and heavy duty materials

Tool Specifications • 10 Pcs/14.0Kg/16.0Kg/0.8'

Square Drive	1/2"
Bolt Capacity	5/8" (M16)
Avg/ Air Con.	4.0 CFM (113 L/min)
Air Inlet	1/4"
Air Pressure	90 PSI (6.2 Bar)
Hose Size I.D.	3/8"
Torque (5 Sec.)	500 FT-LB / 678 N.m.
Max. Torque (10 Sec.)	550 FT-LB / 746 N.m.
Free Speed	8800 RPM
Vibration	9.6 m/s ²
Sound Pressure Level	89.9 Db
Overall Length	3-3/4" (96 mm)
Net Weight	1.34 Kg (2.95 LB)

AW050F

1/2" Stubby Air Impact Wrench



Application



Features

- Mechanism : Twin Hammer
- Highest durable Japanese steel anvil
- Handle exhaust
- Forward 3 position; Reverse : 2 position
- Balanced ergonomic design and low noise with low vibration
- Die casting of housing
- Two piece housing for easy service
- Short Length: Only 4-3/16" from front to rear allows for easy access in cramped spaces
- Components with durable and heavy duty materials

Tool Specifications • 10 Pcs/15.0Kg/17.0Kg/0.8'

Square Drive	1/2"
Bolt Capacity	5/8" (M16)
Avg/ Air Con.	4.0 CFM (113 L/min)
Air Inlet	1/4"
Air Pressure	90 PSI (6.2 Bar)
Hose Size I.D.	3/8"
Torque (5 Sec.)	500 FT-LB / 678 N.m.
Max. Torque (10 Sec.)	550 FT-LB / 746 N.m.
Free Speed	8800 RPM
Vibration	6.7 m/s ²
Sound Pressure Level	89.3 Db
Overall Length	4-3/16" (106 mm)
Net Weight	1.44 Kg (3.17 LB)

1/2" Super Stubby Air Impact Wrench

84mm



AW050H

One hand operation for Forward & Reverse; 3 position for each side
 Replaceable anvil design for short socket & bits or change to traditional anvil of 3/8" and 1/2"
 Short Length: Only 3.3" from front to rear allows for easy access in cramped spaces

AW020A

3/8" Professional Air Impact Wrench



1/2" ANVIL OPTION

Application



Features

- Mechanism: Pin Clutch
- Highest durable grade steel anvil
- Handle exhaust
- Light torque with stability and smoothness
- Forward: 3 position; Reverse 1 position
- Die casting of housing
- Components with durable and heavy duty materials

Tool Specifications • 10 Pcs/16.0Kg/16.6 Kg/0.93'

Square Drive	3/8" / 1/2"
Bolt Capacity	1/2" (M13)
Avg/ Air Con.	3.0 CFM (82 L/min)
Air Inlet	1/4"
Air Pressure	90 PSI (6.2 Bar)
Hose Size I.D.	3/8"
Torque (5 Sec.)	220 FT-LB / 298 N.m.
Max. Torque (10 Sec.)	240 FT-LB / 325 N.m.
Free Speed	9500 RPM
Vibration	4.7 m/s ²
Sound Pressure Level	88 Dba
Overall Length	6-1/2" (165 mm)
Net Weight	1.4 Kg (3.1 LB)

AW020C

3/8" Professional Air Impact Wrench



1/2" ANVIL OPTION

Application



Features

- Mechanism: Pin Clutch
- Highest durable grade steel anvil
- Front exhaust
- Hand push reciprocating forward-reverse switch, and high-low speed regulator
- Die casting of housing
- Ideal for light work application and small part assembly lines
- Components with durable and heavy duty materials
- Kit set available : (Sockets: 9, 10, 11, 12, 14, 17, 19mm)

Tool Specifications • 10 Pcs/15.0 Kg/15.6 Kg/0.93'

Square Drive	3/8" / 1/2"
Bolt Capacity	1/2" (M13)
Avg/ Air Con.	3.0 CFM (85.8 L/min)
Air Inlet	1/4"
Air Pressure	90 PSI (6.2 Bar)
Hose Size I.D.	3/8"
Torque (5 Sec.)	190 FT-LB / 258 N.m.
Max. Torque (10 Sec.)	220 FT-LB / 298 N.m.
Free Speed	10200 RPM
Vibration	4.5 m/s ²
Sound Pressure Level	88 Dba
Overall Length	5-7/8" (150 mm)
Net Weight	1.3 Kg (3.0 LB)

AW020B

3/8" Professional Air Impact Wrench



1/2" ANVIL OPTION

Application



Features

- Mechanism: Jumbo Hammer
- Highest durable grade steel anvil
- Handle exhaust
- Light torque with stability and smoothness
- Forward: 3 position; Reverse 1 position
- Die casting of housing
- Components with durable and heavy duty materials

Tool Specifications • 10 Pcs/15.8 Kg/16.4 Kg/0.93'

Square Drive	3/8" / 1/2"
Bolt Capacity	1/2" (M13)
Avg/ Air Con.	3.0 CFM (85.8 L/min)
Air Inlet	1/4"
Air Pressure	90 PSI (6.2 Bar)
Hose Size I.D.	3/8"
Torque (5 Sec.)	200 FT-LB / 271 N.m.
Max. Torque (10 Sec.)	220 FT-LB / 298 N.m.
Free Speed	9500 RPM
Vibration	4.8 m/s ²
Sound Pressure Level	88 Dba
Overall Length	6-1/2" (165 mm)
Net Weight	1.4 Kg (3.1 LB)

AW030A

3/8" Air Impact Wrench



Application



Features

- Mechanism: Twin Hammer
- Highest durable Japanese steel anvil
- Handle exhaust
- Forward: 3 position; Reverse 1 position
- Die casting of housing
- Ideal for light work application and small part assembly lines
- Components with durable and heavy duty materials

Tool Specifications • 10 Pcs/15.7Kg/16.3Kg/0.93'

Square Drive	3/8"
Bolt Capacity	9/16" (M14)
Avg/ Air Con.	3.0 CFM (85.8 L/min)
Air Inlet	1/4"
Air Pressure	90 PSI (6.2 Bar)
Hose Size I.D.	3/8"
Torque (5 Sec.)	250 FT-LB / 339 N.m.
Max. Torque (10 Sec.)	290 FT-LB / 393 N.m.
Free Speed	10500 RPM
Vibration	4.9 m/s ²
Sound Pressure Level	88 Dba
Overall Length	6-1/2" (165 mm)
Net Weight	1.3 Kg (2.9 LB)

AD312A

High Torque Air Screwdriver



Features

- Mechanism: Pin Clutch
- Pistol type with high torque
- Suit for assembly lines of various industries

Tool Specifications • 10 Pcs/16.95 Kg /17.5 Kg/0.93'

Bolt Capacity	φ3-12
Avg/ Air Con.	2.98 CFM (84 L/min)
Air Inlet	1/4"
Air Pressure	90 PSI (6.2 Bar)
Hose Size I.D.	1/4"
Max. Torque	190 FT-LB / 257 N.m.
Free Speed	9000 RPM
Overall Length	220 mm
Net Weight	1.35 Kg (2.97 LB)

Application



AD314A

High Torque Air Screwdriver



Features

- Mechanism: Pin Clutch
- Pistol type with high torque
- Suit for assembly lines of various industries

Tool Specifications • 10 Pcs/17.45 Kg/18.0 Kg/0.93'

Bolt Capacity	φ3-14
Avg/ Air Con.	3.03 CFM (85.7 L/min)
Air Inlet	1/4"
Air Pressure	90 PSI (6.2 Bar)
Hose Size I.D.	1/4"
Max. Torque	220 FT-LB / 298 N.m.
Free Speed	9500 RPM
Overall Length	220 mm
Net Weight	1.40 Kg (3.10 LB)

Application



AD206A

High Speed Air Screwdriver



Features

- Suit for light work, maintaining and assembling application
- Small size, light weight, small vibration.
- Simple start lever, light weight & save effort.
- Forward & Reverse switching structure.
- Adjustable clutch device provides torque control.
- High speed stepless automatic transmission.

Tool Specifications • 25 Pcs/21.5 Kg/22.1 Kg/1.0'

Bolt Capacity	φ2-5
Avg/ Air Con.	2.3 CFM (63 L/min)
Air Inlet	1/4"
Air Pressure	90 PSI (6.2 Bar)
Hose Size I.D.	1/4"
Max. Torque	33 FT-LB / 45 N.m.
Free Speed	12000 RPM
Overall Length	6-1/2" (165 mm)
Net Weight	0.69 Kg (1.52 LB)

Application



AD409A

High Speed Air Screwdriver



Features

- High speed, powerful, suit for assembly lines of various industries.
- Small vibration.
- Simple start lever, light weight & save effort.
- Forward & Reverse switching structure.
- Adjustable clutch device provides torque control.
- High speed stepless automatic transmission.

Tool Specifications • 25 Pcs/30.0 Kg/30.6 Kg/1.0'

Bolt Capacity	φ4-8
Avg/ Air Con.	3.0 CFM (82 L/min)
Air Inlet	1/4"
Air Pressure	90 PSI (6.2 Bar)
Hose Size I.D.	1/4"
Max. Torque	60 FT-LB / 80 N.m.
Free Speed	8000 RPM
Overall Length	220 mm
Net Weight	1.10 Kg (2.43 LB)

Application





AS090BNV5/6 9.0mm Random Orbital Sander

▲ **Tool Specifications** • 12 Pcs/14.5Kg/15.7Kg/2.8'

Pad size	5" Pad / 6" Pad
Spindle size	5/16"-24 UNF
Free Speed	12,000 rpm
Orbitale Dia	9.0mm
Air pressure	90 PSI
Air Consumption	2.5 CFM
Noise Level	83 Db
Inlet size	1/4" NPT
Weight	0.83 Kgs
Dust system	Non-Vacuum



AS025BNV5/6 2.5mm Random Orbital Sander

▲ **Tool Specifications** • 12 Pcs/14.5Kg/15.7Kg/2.8'

Pad size	5" Pad / 6" Pad
Spindle size	5/16"-24 UNF
Free Speed	12,000 rpm
Orbitale Dia	2.5mm
Air pressure	90 PSI
Air Consumption	2.5 CFM
Noise Level	83 Db
Inlet size	1/4" NPT
Weight	0.83 Kgs
Dust system	Non-Vacuum



AS050BNV5/6 5mm Random Orbital Sander

▲ **Tool Specifications** • 12 Pcs/14.5Kg/15.7Kg/2.8'

Pad size	5" Pad / 6" Pad
Spindle size	5/16"-24 UNF
Free Speed	12,000 rpm
Orbitale Dia	5mm
Air pressure	90 PSI
Air Consumption	2.5 CFM
Noise Level	83 Db
Inlet size	1/4" NPT
Weight	0.83 Kgs
Dust system	Non-Vacuum



AS050ANV Non-Vacuum Palm Air Orbital Sander

▲ **Tool Specifications** • 6 Pcs/7.44Kg/8.44Kg/1.28'

Pad size	5" Pad / 6" Pad
Spindle size	5/16"-24 UNF
Free Speed	10,000 rpm
Orbitale Dia	5mm
Air pressure	90 PSI
Air Consumption	2.5 CFM
Noise Level	83 Db
Inlet size	1/4" NPT
Weight	0.94kgs (2.07 lbs)
Dust system	Non-Vacuum



14T saw blade

AA700A31 Gear Air Saw

▲ **Tool Specifications** • 10 Pcs/11.7Kg/12.2Kg/0.58'

Air inlet	1/4"
Free speed	7,000 RPM
Air pressure	90 PSI (6.2 BAR)
Air hose size	5/16"
Sound level (pressure)	88.5 Db, Kpa:0.45 Db
Sound level (power)	99.5 Db, Kwa:0.38 Db
Avg/ Air Con.	4.0 CFM (28 SCFM)
Vibration	Ahd:18.3 m/sec^2 K:2.31m/sec^2
Weight	2.07 lbs (0.94Kgs)
Length	10.51" (267mm)
Length (storke)	10mm
Packing	14T / 32 T saw blade



AG260C2M Mini Air Die Grinder

▲ Tool Specifications • 20 Pcs/12.0 Kg/12.5 Kg/0.716'

Collet	1/4"
Air inlet	1/4"-18 NPT
Max. free speed	26,000 RPM
Air pressure	90 PSI (6.2 BAR)
Air hose size	5/16"
Sound level	86 Dba
Horse power	0.5 HP
Weight	0.79 lbs (0.36Kgs)
Length	5.28" (134mm)



AG120C2A Air Angle Die Grinder

▲ Tool Specifications • 10 Pcs/13.4Kg/14.4Kg/0.816'

Collet	1/4" / 6mm
Air inlet	1/4"
Max. free speed	12,000 RPM
Air pressure	90 PSI (6.2 BAR)
Air hose size	3/8"
Sound level (pressure / power)	89 Dba / 95 Dba
Vibration	1.7 m/sec ²
Avg/ Air Con.	4.5 CFM (32 SCFM)
Horse power	1.0 HP
Weight	2.29 lbs (1.04Kgs)
Length	9.13" (232mm)



AG200C2A Air Angle Die Grinder

▲ Tool Specifications • 20 Pcs/12.5 Kg/13.0 Kg/0.716'

Collet	1/4"
Air inlet	1/4"-18 NPT
Max. free speed	20,000 RPM
Air pressure	90 PSI (6.2 BAR)
Air hose size	5/16"
Sound level	93 Dba
Avg/ Air Con.	3 CFM (22 SCFM)
Horse power	0.5 HP
Weight	1.10 lbs (0.50Kgs)
Length	5.51" (140mm)



AG230C2E Extended Air Die Grinder

▲ Tool Specifications • 20 Pcs/13.2 Kg/14.2 Kg/1.137'

Collet	1/4" / 6mm
Air inlet	1/4"
Max. free speed	23,000 RPM
Air pressure	90 PSI (6.2 BAR)
Air hose size	5/16"
Sound level	-
Avg/ Air Con.	3.0 CFM (22 SCFM)
Horse power	0.5 HP
Weight	0.68Kgs
Length	268mm



AG200C2S Air Die Grinder

▲ Tool Specifications • 10 Pcs/13.0 Kg/14.0 Kg/0.816'

Collet	1/4" / 6mm
Air inlet	1/4"-18 NPT
Max. free speed	20,000 RPM
Air pressure	90 PSI (6.2 BAR)
Air hose size	3/8" I.D.
Sound level (pressure / power)	85 Dba / 95 Dba
Avg/ Air Con.	4.5 CFM (32 SCFM)
Horse power	1.0 HP
Vibration	1.2 M/sec ²
Weight	2.16 lbs (0.98 Kgs)
Length	8.07" (208mm)



AM100B3T Precision Turbine Grider

▲ Tool Specifications • 10 Pcs/10.5Kg/11.5Kg/1.371'

Collet	1/8" / 3mm
Air inlet	1/4"
Max. free speed	100,000 RPM
Air pressure	90 PSI (6.2 BAR)
Air hose size	3/16" (4.8mm)
Sound level	72.0 Dba
Avg/ Air Con.	1.0 CFM (7.0 SCFM)
Horse power	0.06 HP
Weight	0.66 lbs (0.30Kgs)
Length	7.48" (190mm)
Length (Black color hose)	4'9" (1,450mm)

AM540B3S Air Pencil Die Grider W/Grip



Tool Specifications • 20 Pcs/7.2 Kg/8.0 Kg/1.18'

Collet	1/4" / 6mm
Air inlet	1/4"
Max. free speed	54,000 RPM
Air pressure	90 PSI (6.2 BAR)
Air hose size	1/4" BSP female thread
Sound level (pressure / power)	72.0 DbA / 84.0 DbA
Avg/ Air Con.	0.85 CFM
Weight	0.44 lbs (0.2Kgs)
Length	5-3/8" (137mm)
Length (Black color hose)	4'8"

AM700B3S Air Pencil Die Grider W/Grip



Tool Specifications • 20 Pcs/7.2 Kg/8.0 Kg/1.18'

Collet	1/8" / 3mm
Air inlet	1/4"-18 NPT
Max. free speed	70,000 RPM
Air pressure	90 PSI (6.2 BAR)
Air hose size	5/16"
Sound level (pressure / power)	81 DbA / 86DbA
Avg/ Air Con.	1 CFM (7 SCFM)
Horse power	0.1 HP
Vibration	2.0 m/sec^2
Weight	1.44 lbs (0.20Kgs)
Length	5.38" (137mm)
Length (Black color hose)	4'8"

AM700B3A Right Angle Air Pencil Die Grider W/Grip



Tool Specifications • 20 Pcs/7.40Kg/8.40Kg/1.127'

Collet	1/8"
Air inlet	1/4"
Max. free speed	70,000 RPM
Air pressure	90 PSI (6.2 BAR)
Air hose size	5/16"
Sound level (pressure / power)	72 DbA / 84DbA
Avg/ Air Con.	4.5 CFM (32 SCFM)
Vibration level	1.2 M/sec^2
Weight	0.5 lbs (0.23Kgs)
Length	5.9" (150mm)
Length (Black color hose)	4.9' (1,500mm)

AD203BSS2 Air Screw Driver (2.6-3.0mm)



Tool Specifications

Air inlet	1/8"
Max. free speed	1,000 RPM
Air pressure	90 PSI (6.2 BAR)
Air hose size	3/8"
Avg/ Air Con.	5 CFM
Torque range	0.2-0.7 N.m
Weight	0.34 Kgs
Length	205mm

AD304BSS2 Air Screw Driver (3.0-4.0mm)



Tool Specifications

Air inlet	1/4"
Max. free speed	1,700 RPM
Air pressure	90 PSI (6.2 BAR)
Air hose size	3/8"
Avg/ Air Con.	5 CFM
Torque range	0.7-1.5 N.m
Weight	0.56 Kgs
Length	215mm

AD405BSS2 Air Screw Driver (4.0-5.0mm)



Tool Specifications

Air inlet	1/4"
Max. free speed	1,100 RPM
Air pressure	90 PSI (6.2 BAR)
Air hose size	3/8"
Avg/ Air Con.	5 CFM
Torque range	1.6-2.5 N.m
Weight	0.75 Kgs
Length	235mm



AP808ARM3 Air Spray Gun

Tool Specifications

Type	Gravity
Nozzie Size (mm)	1.3
Fluid Output (c.c/min)	170
Pattern Width (mm)	280
Air Consumption (1/min)	280
Cup Capacity	600 c.c
Air Inlet	1/4" PS
Fluid Inlet	M16x1.5P
Working Pressure	15-28PSI
Gun Weight	450g



AP410AKG4 Air Spray Gun

Tool Specifications • 10 Pcs/9.0Kg/10.0Kg/1.7'

Type	Gravity
Nozzie Size (mm)	1.4
Fluid Output (c.c/min)	220
Pattern Width (mm)	310
Air Consumption (1/min)	280
Cup Capacity	600 c.c
Air Inlet	1/4" PS
Fluid Inlet	M16x1.5P
Working Pressure	30-43PSI
Gun Weight	514g



AP808AHM3 Air Spray Gun

Tool Specifications

Type	Gravity
Nozzie Size (mm)	1.3
Fluid Output (c.c/min)	120
Pattern Width (mm)	330
Air Consumption (1/min)	300
Cup Capacity	600 c.c
Air Inlet	1/4" PS
Fluid Inlet	M16x1.5P
Working Pressure	15-28PSI
Gun Weight	450g



AP410AHG4 Air Spray Gun

Tool Specifications • 10 Pcs/9.0Kg/10.0Kg/1.7'

Type	Gravity
Nozzie Size (mm)	1.4
Fluid Output (c.c/min)	150
Pattern Width (mm)	310
Air Consumption (1/min)	370
Cup Capacity	600 c.c
Air Inlet	1/4" PS
Fluid Inlet	M16x1.5P
Working Pressure	15-28PSI
Gun Weight	514g



AP350AKM1 Air Spray Gun

Tool Specifications • 20 Pcs/10.5Kg/11.5Kg/1.2'

Type	Gravity
Nozzie Size (mm)	1.0
Fluid Output (c.c/min)	90
Pattern Width (mm)	140
Air Consumption (1/min)	109
Cup Capacity	125 c.c
Air Inlet	1/4" PS
Fluid Inlet	M14x1.0P
Working Pressure	15-28PSI
Gun Weight	280g



AP501AKS4 Air Spray Gun

Tool Specifications

Type	Suction
Nozzie Size (mm)	1.4
Fluid Output (c.c/min)	190
Pattern Width (mm)	265
Air Consumption (1/min)	190
Cup Capacity	700 c.c / 1000 c.c
Air Inlet	1/4" PS
Fluid Inlet	1/4" PS / 3/8" PS
Working Pressure	30-45PSI
Gun Weight	460g

